



150 W. Jefferson Street, Joliet IL 60432

Media Release

Contact: Communications Office 815.724.4462 [rbarker@jolietcity.org](mailto:rbarker@jolietcity.org)

---

July 22, 2010

## Route 30/Jefferson Street Bridge Closure Beginning Tuesday July 27, 2010

Route 30/Jefferson Street Bridge will be closed beginning Tuesday, July 27, 2010, due to Illinois Department of Transportation mechanical maintenance, including the replacement of the pinion racks.

The bridge will be closed from July 27 through late August.

A detour will be posted for utilizing southbound Raynor Avenue, eastbound McDonough Street, and northbound Chicago/Scott Streets. A Class II truck detour will also be posted utilizing southbound Larkin Avenue and eastbound I-80 to the intersection of Route 30. (See attached)

The City of Joliet is the fourth largest city in the state of Illinois, located just 45 miles southwest of Chicago's Loop. Home to over 152,000 residents, in addition to thriving businesses and attractions, the City of Joliet is easily accessible by rail, auto and bus transit. A perfect place to live, work and play, Joliet is constantly striving to promote growth and diversity. For more information on Joliet visit [www.visitjoliet.org](http://www.visitjoliet.org) or call 815.724.4000.

###

# DETOUR MAPS

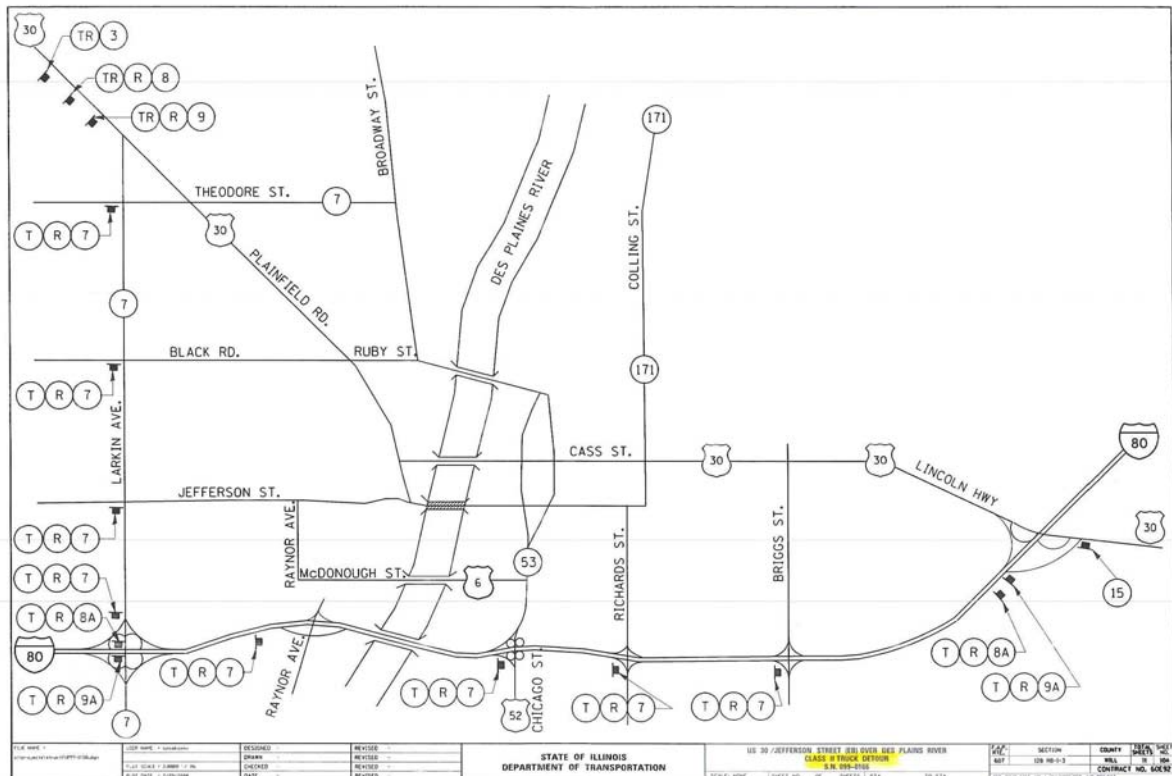
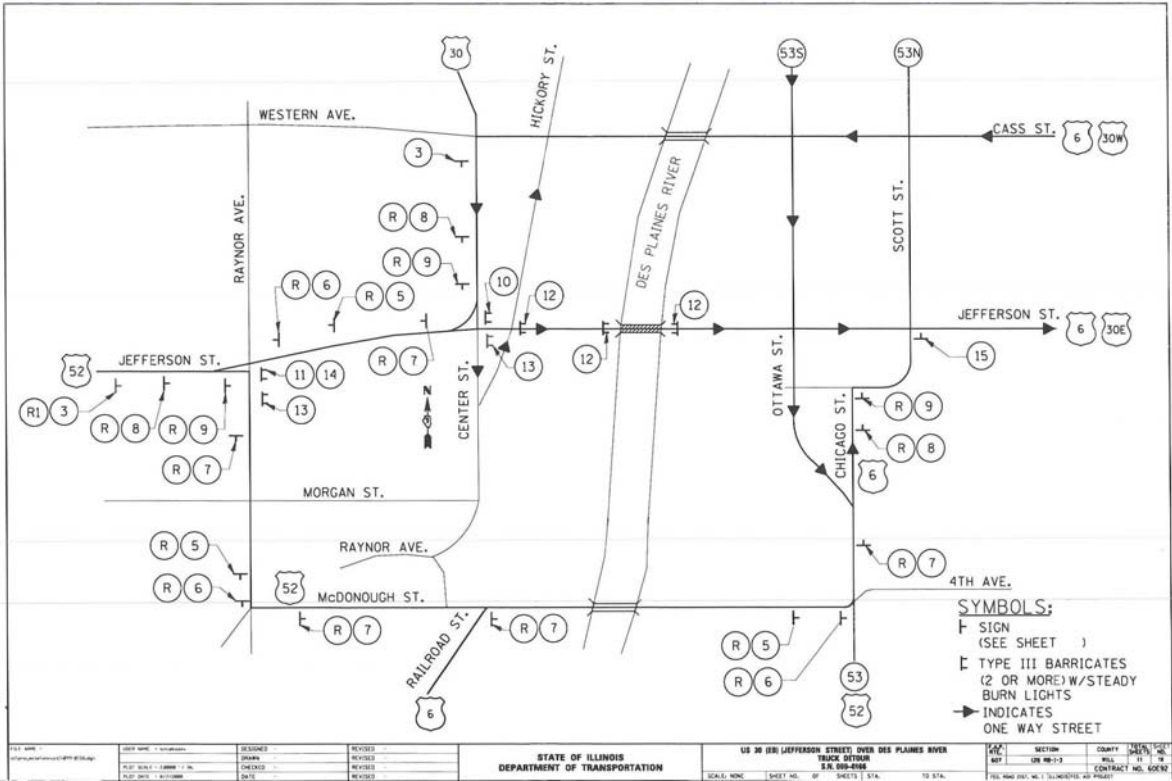

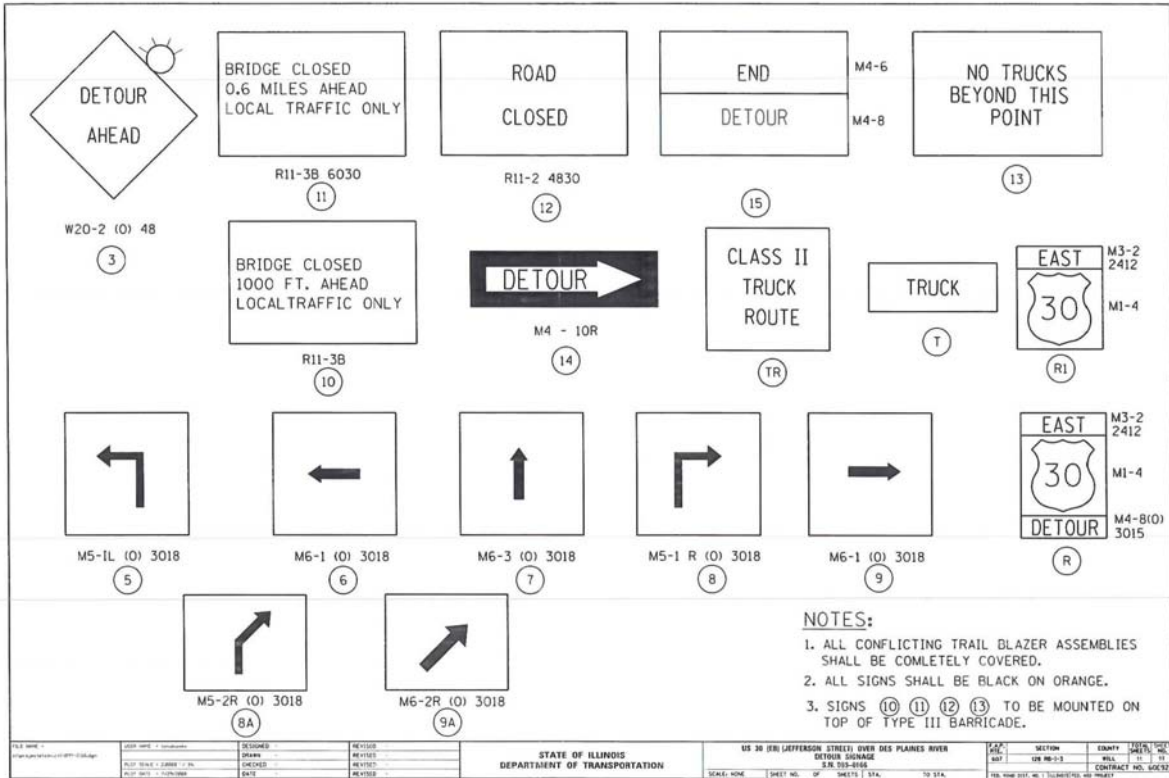

- NOTES:**
1. ALL CONFLICTING TRAIL BLAZER ASSEMBLIES SHALL BE COMPLETELY COVERED.
  2. ALL SIGNS SHALL BE BLACK ON ORANGE.
  3. SIGNS (10) (11) (12) (13) TO BE MOUNTED ON TOP OF TYPE III BARRICADE.

FILE NO.	DATE	DESIGNED	REVISED	STATE OF ILLINOIS DEPARTMENT OF TRANSPORTATION	US 30 (E. LEFFERSON STREET) OVER DES PLAINES RIVER DETOUR SIGNAGE S.R. 100-4000	SHEET NO.	SECTION	COUNTY	CONTRACT NO.
100-4000-100	10/1/00	J. J. J.				100	100-4000-100	DEWITT	100-4000-100
DATE	BY	BY	BY						